



Lauderdale

B o o r a l

Your piece of paradise





Plenty of space for gardens or room to play

Lauderdale Booral is your answer to living with space, privacy and a beautiful semi-rural outlook whilst being just minutes to town. This is your opportunity to live your ideal lifestyle at an affordable price.

Lauderdale is located a short drive from everything you need with all the privacy you've dreamt of. It's less than 10 minutes' drive to shopping and schools, and a short 5 minute drive to

boat ramps, making it an ideal location for retirees and families alike.

Design and build your dream home on a half-acre block. There's no need to compromise on space, with plenty of room for a shed, swimming pool, and a big backyard for cricket, your very own veggie patch and fruit orchard.



Generously sized 2000m² blocks



Relax and enjoy the semi-rural outlook



Views to Fraser Island & The Great Sandy Straits



- Your choice of builder
- Buy land-only or select from a range of turnkey house and land packages by Hervey Bay's leading builders
- Relax and enjoy the semi-rural outlook
- Enjoy all the benefits of the relaxed Hervey Bay lifestyle, with easy access to shopping, schools, medical and recreation facilities
- Town water and underground power



Lauderdale

Booral

Your piece of paradise



MAJOR FACILITY GUIDE

- | | | | |
|-------------------------------|----------------------------------------------|----------------------------------------------------------|-----------------------------------------------|
| Shopping | Education | 10 Village Kids Childcare | 16 TAFE East Coast |
| 1 Urrangan Shopping Centre | 5 Bay Explorers Early Learning and Childcare | 11 Star of the Sea Catholic Primary School and Childcare | 17 University of Sunshine Coast, Fraser Coast |
| 2 Stockland Hervey Bay | 6 Paisley Park Early Learning | 12 Fraser Coast Anglican College | Recreation |
| Medical | 7 Urrangan Point State School | 13 St James Lutheran College | 18 Hervey Bay Golf Club |
| 3 Urrangan Medical Centre | 8 Urrangan State High School | 14 Bayside Christian College | 19 Urrangan Marina and Boat Ramp |
| 4 Hervey Bay Medical Precinct | 9 Sandy Straits State School | 15 Xavier Catholic College | 20 River Heads Ferry Terminal and Boat Ramp |

Contact us to enquire or arrange an inspection.

www.lauderdaleherveybay.com.au

0408 619 491

rod@herveybayhouseandland.com.au

Disclaimer: Images and representations are indicative only. Whilst all care is taken in the production of the publication, no liability for negligence is assumed by the publisher. Prospective purchasers should inform and assure themselves by inspection, independent advice or as otherwise necessary prior to making any purchase. October 2018.



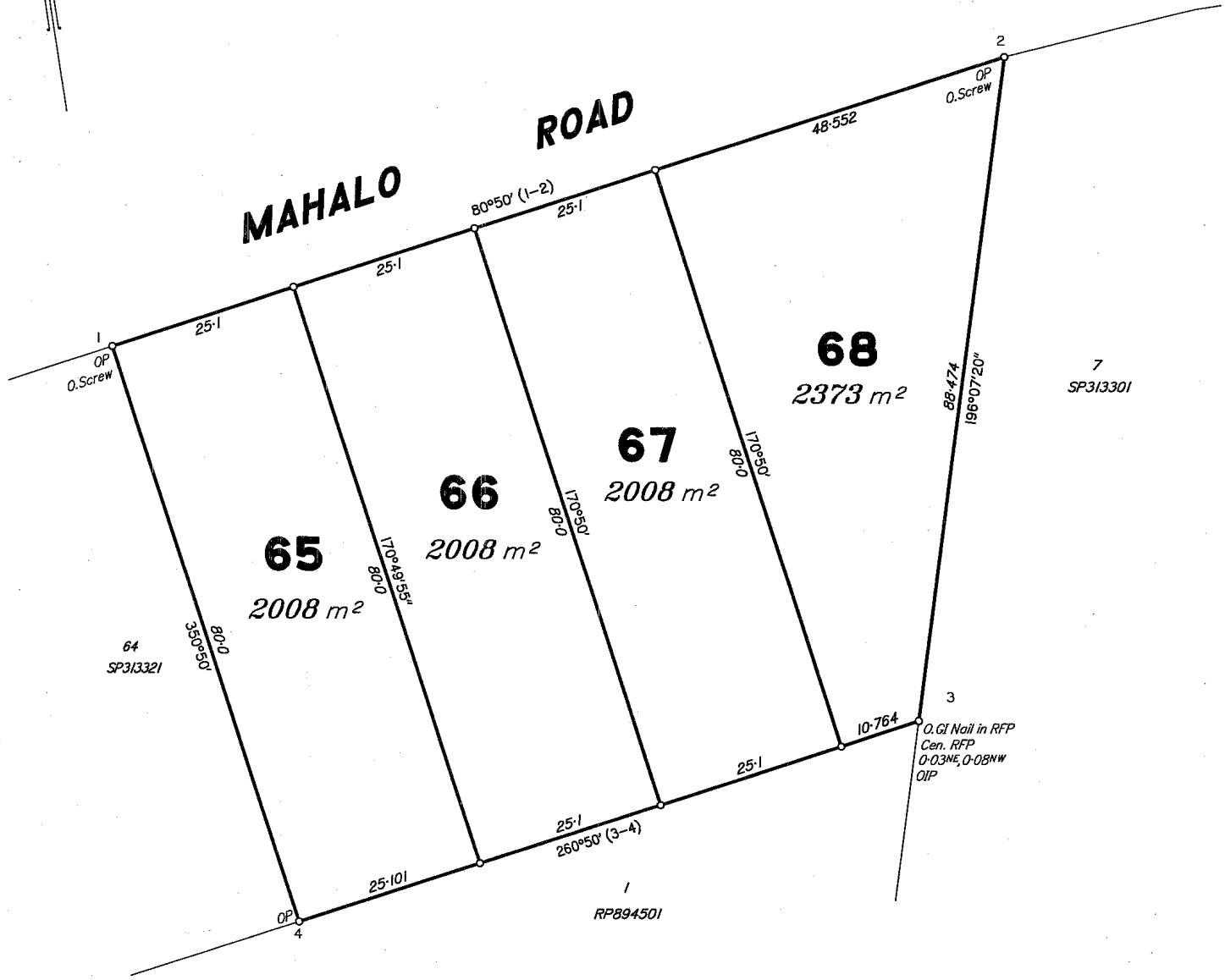

REINSTATEMENT REPORT

Plans searched, SP323900 & SP313301.

SP323901 is a subsequent plan of a staged development.
All reinstated dimensions agree with previous surveys.

Scale 1:600 - Lengths are in Metres.

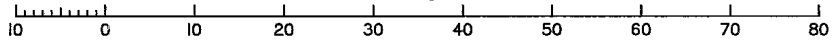

PACIFIC COAST SURVEYS (Aust) PTY LTD (ABN 33 120 271 052) hereby certify that the land comprised in this plan was surveyed by the corporation, by Philip Martin O'DONOGHUE, cadastral surveyor, for whose work the corporation accepts responsibility, and that the plan is accurate, that the said survey was performed in accordance with the Survey and Mapping Infrastructure Act 2003 and Surveyors Act 2003 and associated Regulations and Standards and that the said survey was completed on 4/11/2020

Director

Director

Date

Plan of Lots 65-68

Cancelling Lot 80 on SP323900

LOCAL

GOVERNMENT: *Fraser Coast R.C.*

LOCALITY: *Booral*

Meridian: *MGA Zone 56 vide SP281496*

Survey Records: *No*

Scale: **1:600**

Format: **STANDARD**

SP323901

State copyright reserved.