

Hervey Bay's best value new address.



Ready Built Home - Under Construction

Artist Impression, landscaping not included

Ivy

Fixed Price **\$312,000**

Lot 226 63 Imperial Circuit, Eli Waters
 Area House: 150m² Land: 450m²

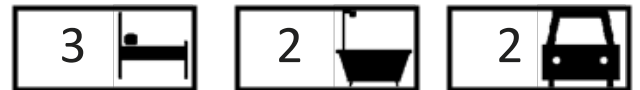

SUPERIOR INCLUSIONS

- Open plan living with Colorbond roof to patio
- Ceramic cooktop, rangehood & fan-forced oven
- 1^{3/4} bowl stainless steel sink
- Dishwasher space provided
- Ensuite & W.I.R, to bed 1, built-in robes to all bedrooms
- Vinyl plank flooring to entry, kitchen, family/dining & hall
- Carpet to lounge & bedrooms
- Ceiling fans to family room & bedrooms
- Double remote lock up garage with internal access
- Vertical drapes to living areas
- Safety screens to opening windows and doors
- Electric hot water system
- 3 coat paint system to interior
- Timber frame & trusses. Full termite treatment to slab
- Concrete driveway and path to entry
- Letterbox and clothesline
- Fully fenced to house alignment with gates and returns
- Up to 300m² turf to front/rear yards
- Six star energy efficiency rating

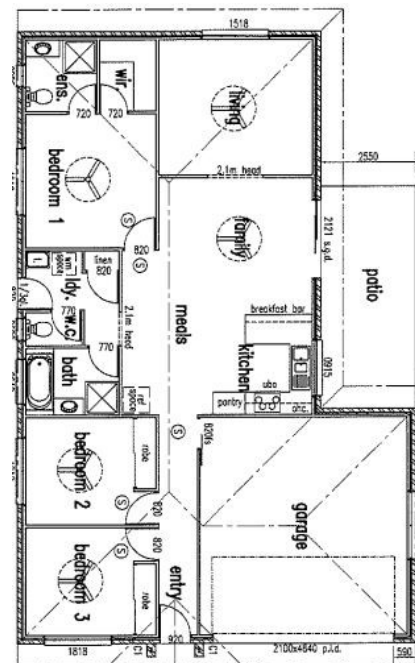

Rod Marks
 m: 0408 619 491
 e: rod@herveybayhouseandland.com.au
 w: herveybayhouseandland.com.au

*Prices & completion date correct at time of publication, and subject to change without notice. 11 Apr 2019.



HOUSE & LAND
 Hervey Bay