

Hervey Bay's best
value new address.

**Ready Built Home
Complete due July 2020**

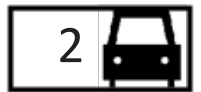

Image is indicative of Nicola design, however façade, colours and finishes may vary.

Nicola 209 Lot 327 Imperial Cct, Eli Waters **Fixed Price \$401,000**

House: 209m²

Land: 606m²



Style and sophistication

You'll love coming home to this stylish family home in Eli Waters. The Nicola 209 is packed full of great design elements, from the grand street presentation with symmetrical roof line and raised portico to the double stacker doors opening to the rear alfresco.

The large, north/east facing open plan living area is the main feature of this home, While the centrally located kitchen makes entertaining a breeze. Double stacker doors open the living areas directly onto the under roof alfresco.

The main bedroom is located at the front of the home and includes a generous sized ensuite and walk in robe. The 3 other bedrooms all have built-in robes and are located towards the back of the home, separate from the living areas. This home has just about everything you need to move straight in with fences, turf, driveway, and floor coverings.

Sited on a 606m² block this spacious family home has 4 bedrooms, 2 living area, under roof alfresco, plus secondary street access with room for a pool in the back yard. Now under construction, this home is due to complete in July 2020.

Other homes available from \$369,900. **To arrange a private viewing phone Rod on 0408 619 491.**

Rod Marks
m: 0408 619 491
e: rod@herveybayhouseandland.com.au
w: herveybayhouseandland.com.au

*Prices & completion date correct at time of publication, and subject to change without notice. Images are indicative of the Nicola design, not of this specific property. Specifications, colours and finishes may vary. 1 May 2020



HOUSE & LAND
Hervey Bay

Hervey Bay's best value new address.

Nicola 209 Lot 327 Imperial Cct , Eli Waters Fixed Price **\$401,000**

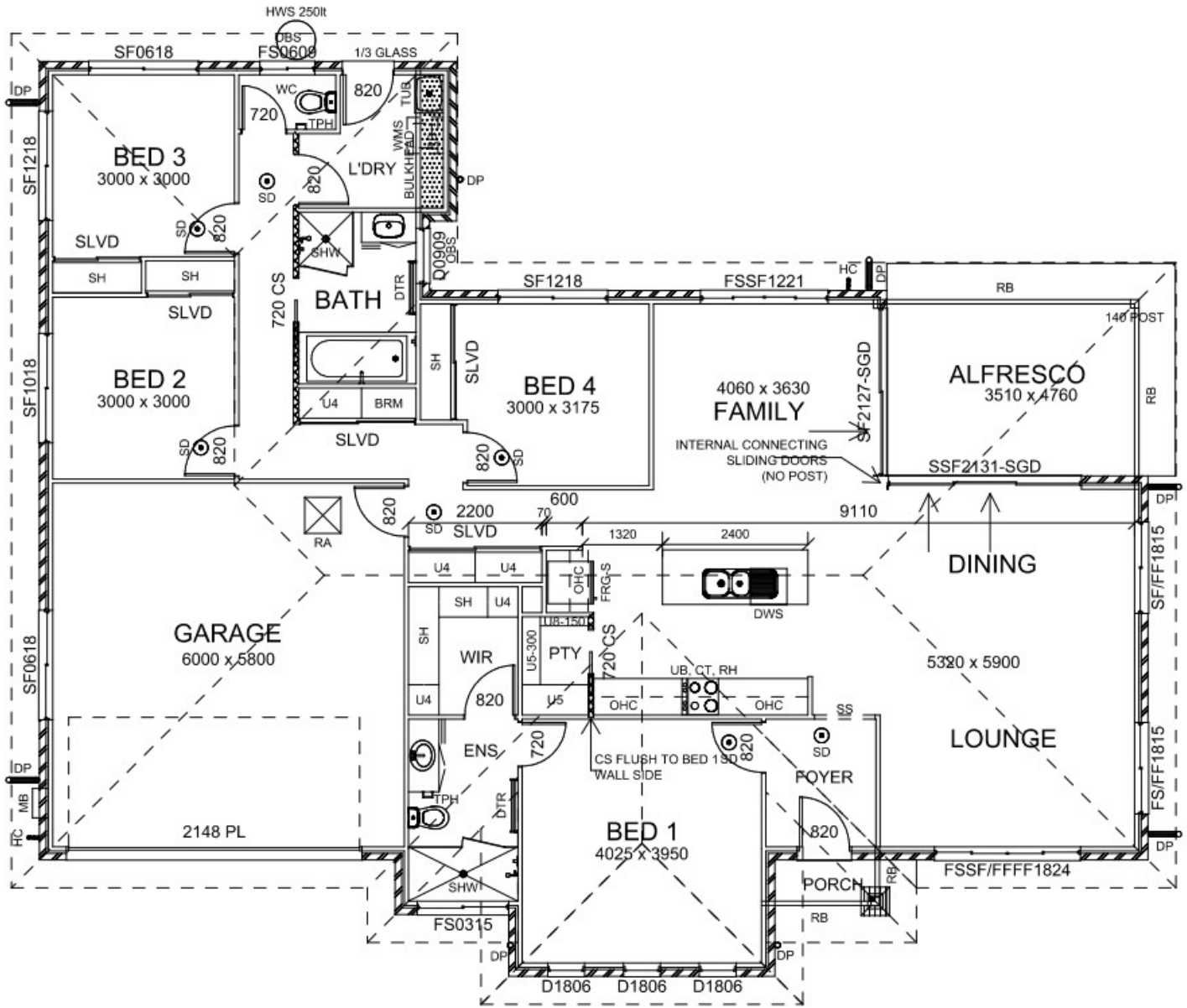
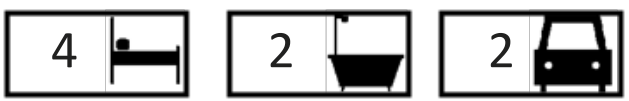

Rod Marks
 m: 0408 619 491
 e: rod@herveybayhouseandland.com.au
 w: herveybayhouseandland.com.au



*Prices & completion date correct at time of publication, and subject to change without notice. Images are indicative of the Nicola design, not of this specific property. Specifications, colours and finishes may vary. 1 May 2020