

**Build start March/April '21**



Image is indicative of Ivy design, however façade, inclusions, colours and finishes may vary.

**Ivy**

Lot 403 Waterside Way, Eli Waters

**\$334,000**

House: 150m<sup>2</sup>

Land: 450m<sup>2</sup>



### Low maintenance home

Enjoy your leisure time in this low maintenance 3 bedroom home on a 450m<sup>2</sup> block overlooking open space. Close to schools, shops and medical centre. The Sanctuary is an ideal location for young couples and retirees alike. This home is commencing soon and comes complete with turn key inclusions.

#### Superior Inclusions

- Laminate benchtops to kitchen
- 600mm S/S oven, ceramic cooktop
- Canopy rangehood & dishwasher space
- Carpet to bedrooms
- Vinyl planks to entry, living, lounge and wet areas
- Ceiling fans to living and bedrooms
- Vertical blinds to all living areas
- Safety screens to doors and windows
- 350m<sup>2</sup> of turf
- Plain concrete driveway and entry
- Covered patio with concrete slab
- Brick letterbox
- 250l electric hot water system
- Fold out clothesline
- Remote panel lift garage door
- Fully fenced to house alignment
- Double side gate access to back yard
- Ceiling insulation & 6 star energy efficiency

Sign a contract before 31 March 2021 and you may be eligible for \$20,000 in New Home Grants.

**Rod Marks**  
m: 0408 619 491  
e: [rod@herveybayhouseandland.com.au](mailto:rod@herveybayhouseandland.com.au)  
w: [herveybayhouseandland.com.au](http://herveybayhouseandland.com.au)

\*Prices & completion date correct at time of publication, and subject to change without notice. Images are indicative of the Ivy design, not of this specific property. Specifications, colours and finishes may vary. 19 Feb 2020



**HOUSE & LAND**  
Hervey Bay

Ivy

Lot 403 Waterside Way, Eli Waters

\$334,000

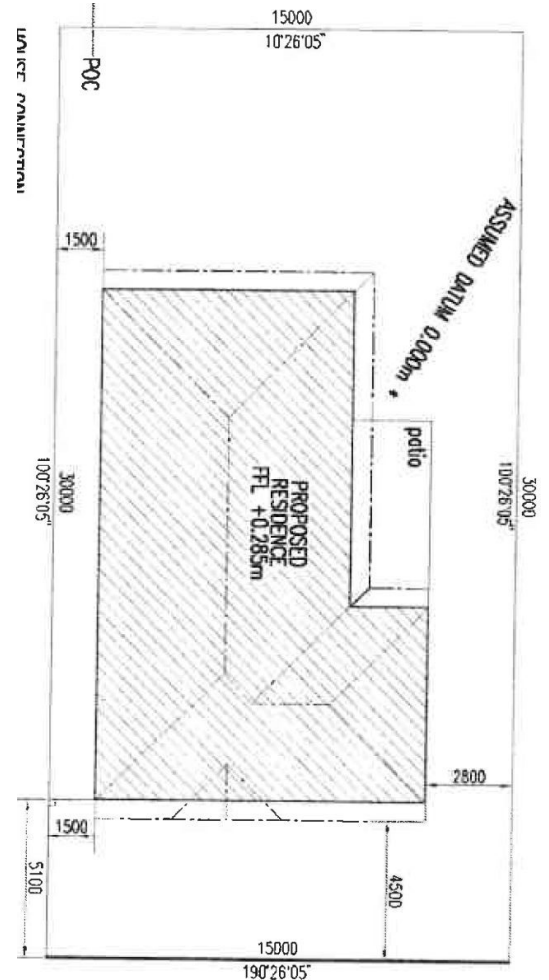
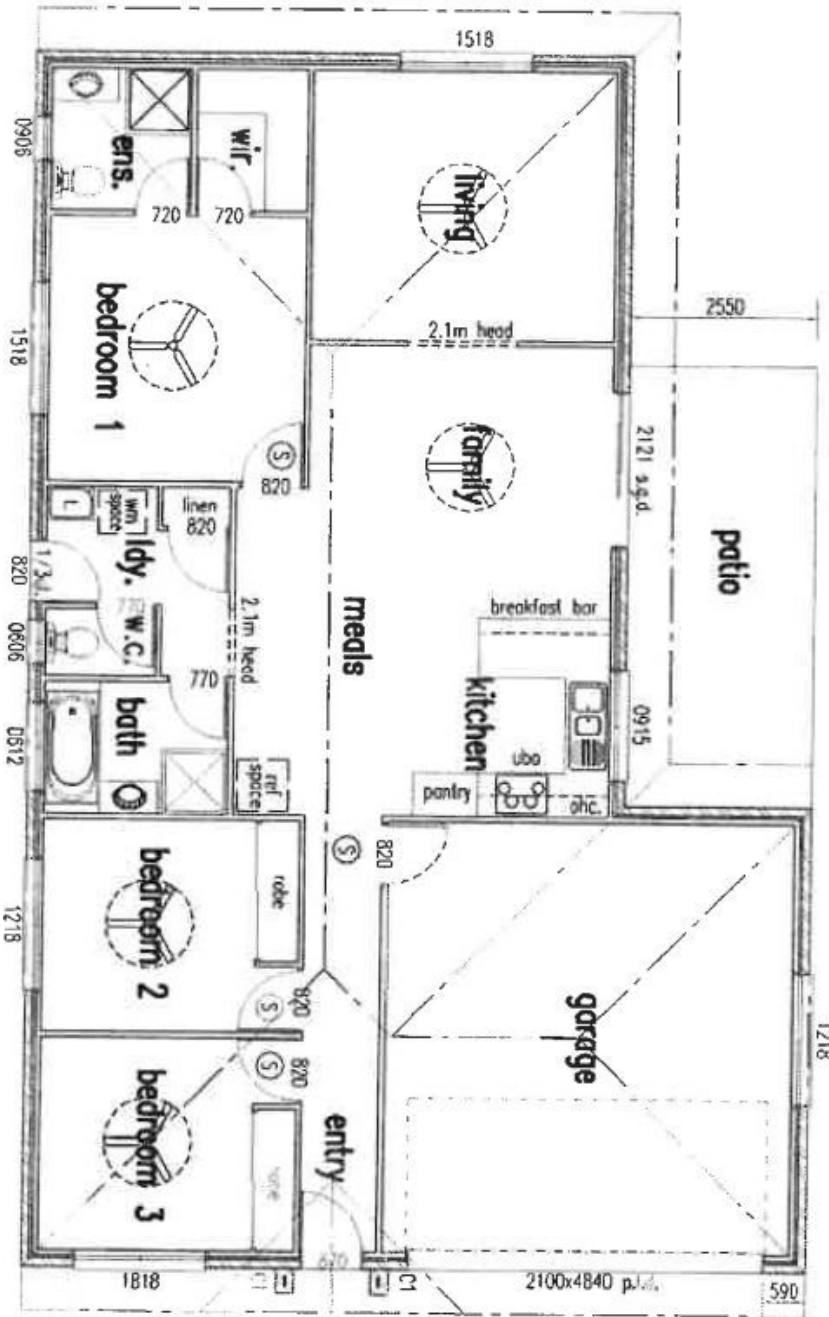

Rod Marks  
m: 0408 619 491  
e: rod@herveybayhouseandland.com.au  
w: herveybayhouseandland.com.au

\*Prices & completion date correct at time of publication, and subject to change without notice. Images are indicative of the Ivy design, not of this specific property. Specifications, colours and finishes may vary. 19 Feb 2020



**HOUSE & LAND**  
Hervey Bay