

**Construction commencing
mid 2021**



Image is indicative of Stacey design, however façade, inclusions, colours and finishes may vary.

Stacey 173

Lot 442 Seagrass Lane, Eli Waters

\$364,700

House: 173m²

Land: 375m²

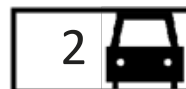

Low maintenance living at its best

This quality 3 bedroom home is ideal for year round entertaining. The generous kitchen with island bench overlooks the dining and living areas and connects seamlessly to the under roof alfresco. The north east facing alfresco will pick up northerly breezes to keep you cool in summer.

Sited on a low maintenance 375m² block, this new home let's enjoy life without the hassle of mowing a big back yard. Cleverly designed this home has a drive-through garage so you can keep your tinnie, or golf buggy secure in your back yard.

The main bedroom is located at the back of the home and includes an ensuite and walk in robe. The 2 other bedrooms have built-in robes, with bed 3 having access to a two-way bathroom. This home has just about everything you need to move straight in with fences, turf, driveway, and floor coverings included.

Located within a few minutes walk to the lake and walking trails, plus you're only 5 minutes drive to Eli Waters Shopping Centre, Yarrilee State School, Xavier Catholic College and Eli Waters Medical Centre.

Sign contracts before 31 March 2021 before the Homebuilder grant expires. Phone today to secure your new home.

Rod Marks
m: 0408 619 491
e: rod@herveybayhouseandland.com.au
w: herveybayhouseandland.com.au

*Prices & completion date correct at time of publication, and subject to change without notice. Images are indicative of the Stacey design, not of this specific property. Specifications, colours and finishes may vary. 12 March 2021



HOUSE & LAND
Hervey Bay

Stacey

Lot 442 Seagrass Lane, Eli Waters

\$364,700

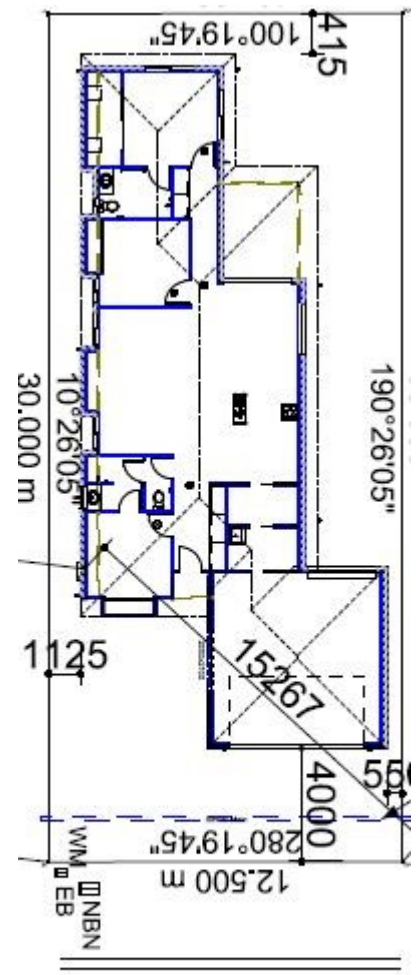
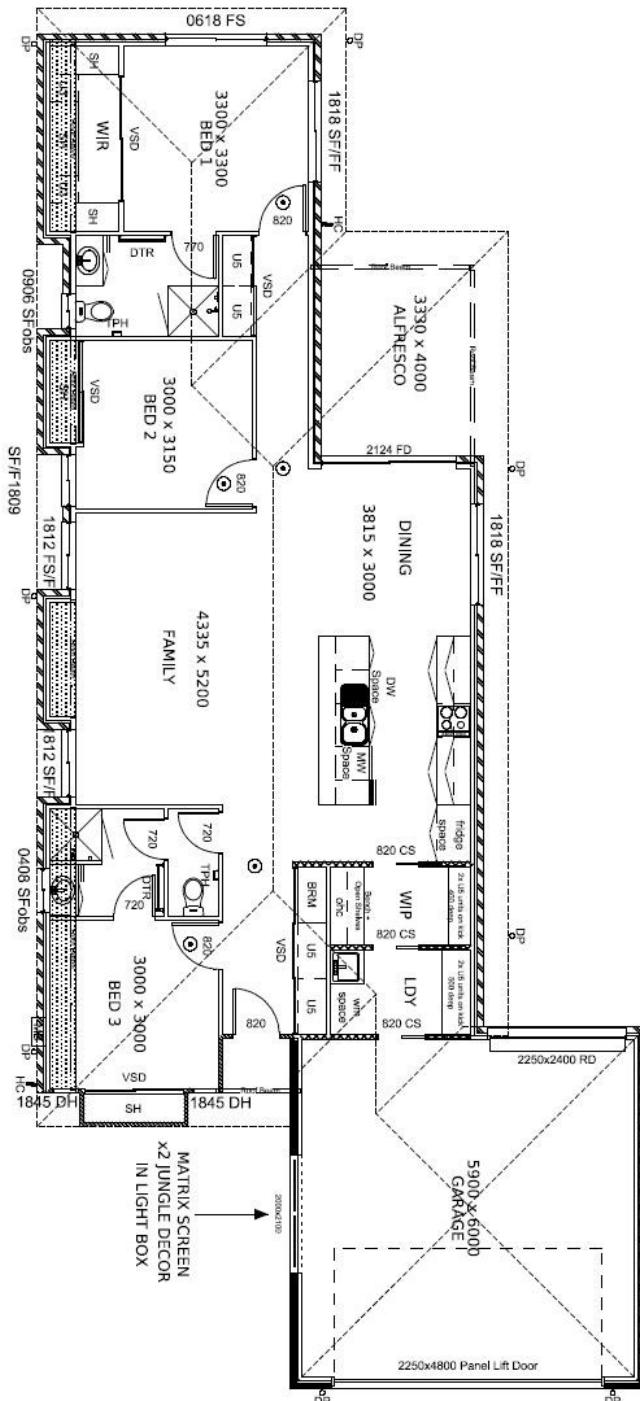
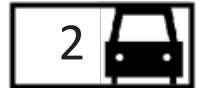
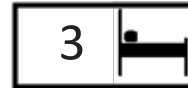

SEAGRASS LANE

Rod Marks
m: 0408 619 491
e: rod@herveybayhouseandland.com.au
w: herveybayhouseandland.com.au

*Prices & completion date correct at time of publication, and subject to change without notice. Images are indicative of the Stacey design, not of this specific property. Specifications, colours and finishes may vary. 12 March 2021



HOUSE & LAND
Hervey Bay