

**Ready Built Home
Completion due Sept 2020**



Image indicative of typical Violet design. Specifications, colours & finishes may vary.

Violet

Lot 518 Sailaway Cct, Eli Waters

Fixed Price

\$323,000

House: 166m²

Land: 480m²

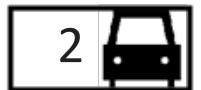

SUPERIOR INCLUSIONS

- Open plan living with Colorbond roof to patio
- Ceramic cooktop, rangehood & fan-forced oven
- 1^{3/4} bowl stainless steel sink
- Dishwasher space provided
- Ensuite & W.I.R. to bed 1, built-in robes to all bedrooms
- Vinyl plank flooring to entry, kitchen, family/dining & hall
- Carpet to lounge & bedrooms
- 6 Ceiling fans to family room & bedrooms
- Double remote lock up garage with internal access
- Vertical drapes to living areas
- Safety screens to opening windows and doors
- Electric hot water system
- 3 coat paint system to interior
- Timber frame & trusses. Full termite treatment to slab
- Concrete driveway and path to entry
- Letterbox and clothesline
- Fully fenced to house alignment with gates and returns
- Up to 350m² turf to front/rear yards



Rod Marks
m: 0408 619 491
e: rod@herveybayhouseandland.com.au
w: herveybayhouseandland.com.au



HOUSE & LAND
Hervey Bay

*Prices & completion date correct at time of publication, and subject to change without notice. Image indicative of typical Violet design. Specifications, colours and finishes may vary. 21 April 2020

Violet

Lot 518 Sailway Cct, Eli Waters

Fixed Price **\$323,000**

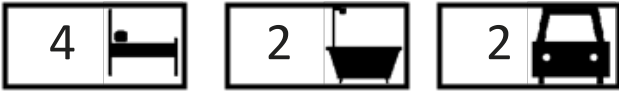

SAILWAY CIRCUIT

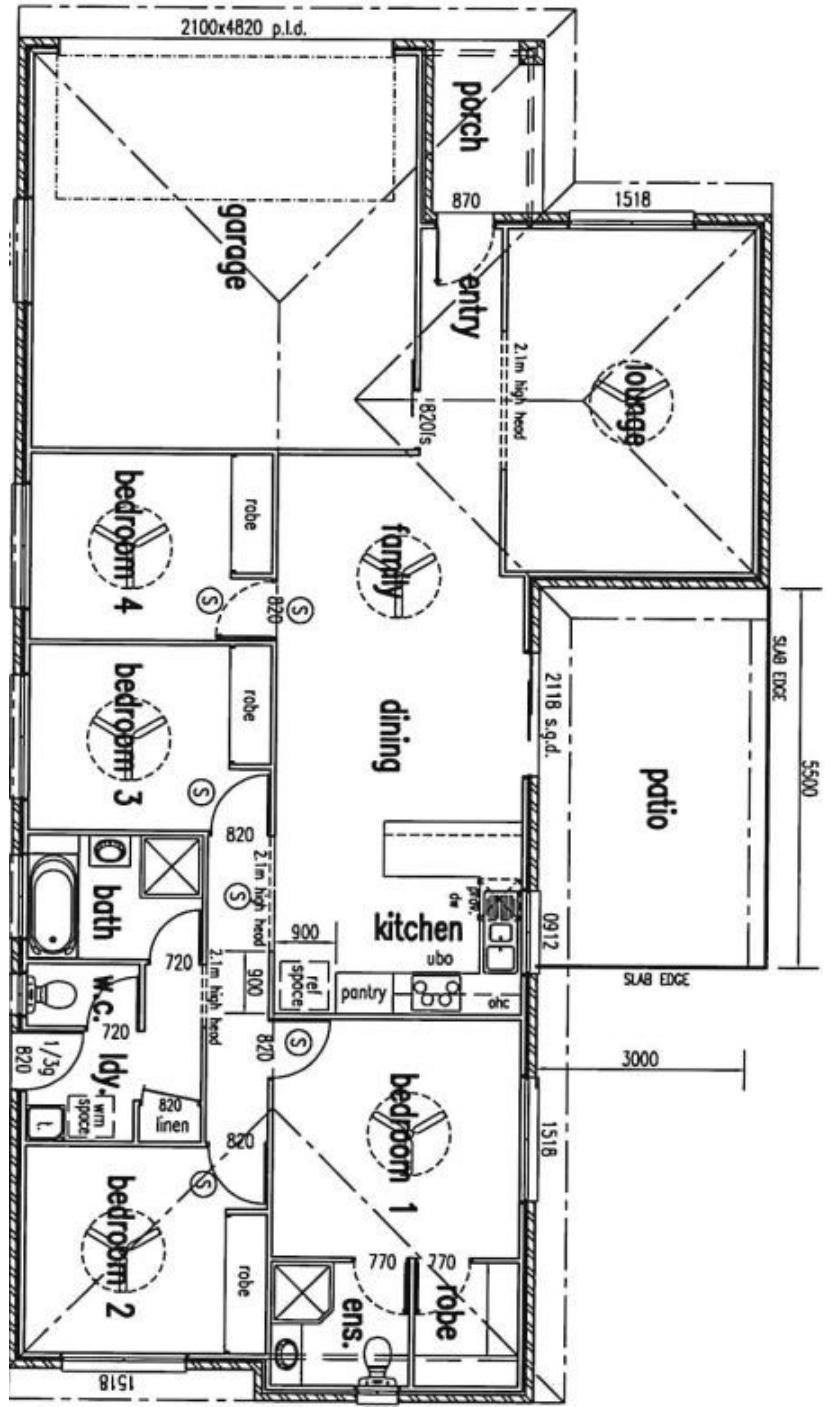
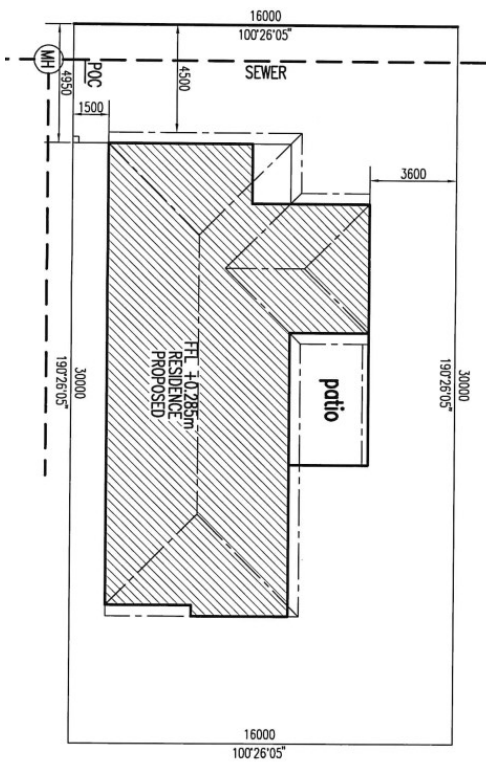

Rod Marks
 m: 0408 619 491
 e: rod@herveybayhouseandland.com.au
 w: herveybayhouseandland.com.au

*Prices & completion date correct at time of publication, and subject to change without notice. Image indicative of typical Violet design. Specifications, colours and finishes may vary. 21 April 2020



HOUSE & LAND
 Hervey Bay