

Hervey Bay's best value new address.

Ready Built Home - Under Construction



Image is mirror reversed, colours and materials may vary. Landscaping not included.

The 'Violet'

Violet

Fixed Price **\$316,000**

Lot 117 8 Samphire Street Eli Waters
 Area House: 166m² Land: 480m²

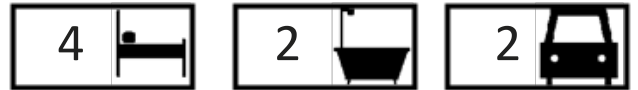

INCLUSIONS

- Open plan living with Colorbond roof to patio
- Ceramic cooktop, rangehood & fan-forced oven
- 1^{3/4} bowl stainless steel sink
- Dishwasher space provided
- Ensuite & W.I.R, to bed 1, built-in robes to all bedrooms
- Vinyl plank flooring to entry, kitchen, family/meals & hall
- Carpet to lounge & bedrooms
- 6 Ceiling fans to family room & bedrooms
- Double remote lock up garage with internal access
- Vertical drapes to living areas
- Safety screens to opening windows and doors
- Electric hot water system
- 3 coat paint system to interior
- Timber frame & trusses. Full termite treatment to slab
- Concrete driveway and path to entry
- Letterbox and clothesline
- Fully fenced to house alignment with gates and returns
- Up to 350m² turf to front/rear yards
- Six star energy efficiency rating

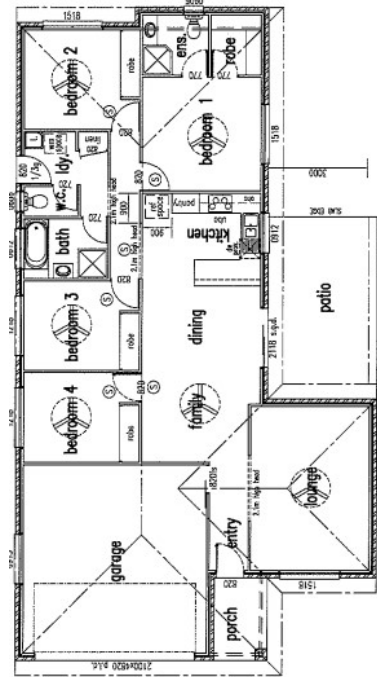

Rod Marks

m: 0408 619 491

e: rod@herveybayhouseandland.com.au

w: herveybayhouseandland.com.au

*Prices correct at time of publication, but subject to change without notice. 26 Oct 2018.



HOUSE & LAND
Hervey Bay